



Dealer: _____ Phone: _____ Client: _____
 Contact: _____ Email: _____
 Address: _____ PO#: _____ Date: _____
 City/State/Zip: _____

LEVO USA
 7105 Northland Terrace
 Brooklyn Park, MN 55428
 888.538.6872
 888.LevoUSA
 763.582.0442 FAX
 sales@levousa.com
 AmyJ@levousa.com
 www.levousa.com



Purchasing through (funding source): _____
Standard Base Configuration \$12,875

- Manually Propelled Wheelchair with Power Standing System
- Maximum Client Weight: 265 lbs.
- Powered Actuator with Gas Strut Assist to Stand
- Tension Adjustable Seat & Back Upholstery
- Fold Down, Angle Adjustable Backrest
- Rear Wheel - 24"x1" high pressure pneumatic, hub black, spoke silver
- Front caster - 5"x1" solid rubber, composite wheel
- Standard colors: platinum, red, yellow, blue or black
- One Piece Footplate - Fixed
- 0 Degree Rear Wheel Camber

Anatomical Dimensions

Weight:

Height:

Hip Width: ①

Upper Leg Length: ②

Lower Leg Length: ③

Seat to Elbow: ④

Chest Width: ⑤

Chest Depth: ⑥

Floor to top of knee: ⑦

Seat to Top of Shoulder: ⑧

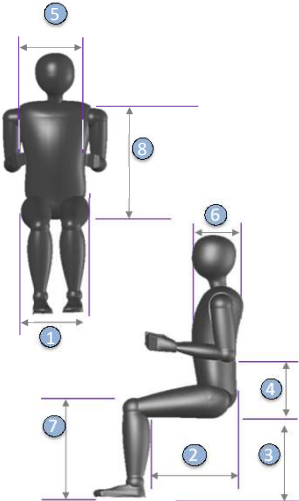

① Hip width > Seat width

Hip width:

①

Seat width:	
13.75"	Option
15"	Option
15.75"	Option
16.5"	Option
17.75"	Option
19"	WAMA \$ 350
20.75"	WAMA \$ 1,036

② Upper leg length/Seat depth (upholstery)

There are two frame lengths for the LCEV (S-M & L-XL)
 Each offers a range of seat depths utilizing the adjustable upper and lower seat rails.

When fit correctly, the *Seat depth (upholstery)* is approximately 2.5" less than the *Upper leg length* measurement.

Upper leg length:

②

Frame	Seat depth (upholstery):	
S-M Frame	11.5"	Option
	12"	Option
	13"	Option
	14"	Option
	15"	Option
	16"	Option
L-XL Frame	17"	Option
	18"	Option
	18.5"	WAMB \$ 199
	19.5"	WAMB \$ 199
	21"	WAMB \$ 199

③ Lower leg length/Seat to footplate

The *Lower leg length* determines the *Seat to footplate* setting, possible wheel/caster combinations and front seat heights.

Please take the cushion into consideration when choosing the *Seat to footplate* setting.

Lower leg length:

③

Seat Height Front: ▶	19"	20"	21"	22.5"	
Seat to footplate: ▼					Rear seat height is approximately 1.5" lower than front
	22" rear wheel 5" front caste	24" rear wheel 5" front caste	24" rear wheel 5" front caste	26" rear wheel* 6" front caster*	
14"	<input type="checkbox"/>				
15"	<input type="checkbox"/>				
15.75"	<input type="checkbox"/>	<input type="checkbox"/>			
16.5"	<input type="checkbox"/>	<input type="checkbox"/>			
17.25"	<input type="checkbox"/>	<input type="checkbox"/>	<input type="checkbox"/>		
18"		<input type="checkbox"/>	<input type="checkbox"/>		
19"		<input type="checkbox"/>	<input type="checkbox"/>	<input type="checkbox"/>	
19.75"			<input type="checkbox"/>	<input type="checkbox"/>	
20.5"			<input type="checkbox"/>	<input type="checkbox"/>	
21.25"				<input type="checkbox"/>	
22"				<input type="checkbox"/>	

*see Wheel options on page 4

Armrest

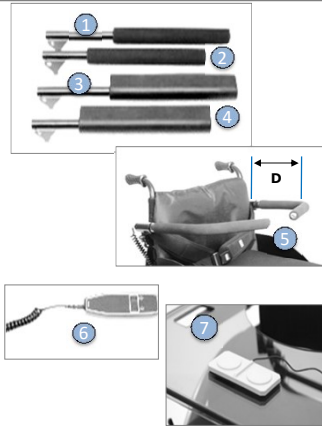

Arm height
 Note: Please consider cushion thickness when choosing the arm height

Seat to elbow:

5.5" min 8.75" max

- 1 Armrest - long, round with foam pad
- 2 Armrest - short, round with foam pad
- 3 Armrest - lng" 2.4" wide polyurethane pad
- 4 Armrest - shr" 2.4" wide polyurethane pad
- 5 Armrest - Chest support, with bend

Choose "D" dimension:

Flip up and rotate out, with round tube and foam pad only
 Distance to beginning of bend, see picture at left

- 6 Standing control
 - Switch in arm - left
 - Switch in arm - right
 - Pendant

- 7 Dual switch for table tray control
 Tray table not included

Option	<input type="text"/>	\$99
Std.	<input type="text"/>	•
Option	<input type="text"/>	\$339
Option	<input type="text"/>	\$232
Option	<input type="text"/>	\$697

Option	<input type="text"/>	\$99
Option	<input type="text"/>	\$99
Option	<input type="text"/>	•
Option	<input type="text"/>	•
Option	<input type="text"/>	•

Frame color

- Black
- Blue
- Platinum
- Red
- Yellow

Std.	<input type="text"/>	•
Option	<input type="text"/>	•
Option	<input type="text"/>	•
Option	<input type="text"/>	•
Option	<input type="text"/>	•

- Blue metallic
- Green metallic
- Red metallic
- Silver metallic

Option	<input type="text"/>	595.00
Option	<input type="text"/>	595.00
Option	<input type="text"/>	595.00
Option	<input type="text"/>	595.00

- Orange reflex
- Lemon reflex
- Silver reflex

Option	<input type="text"/>	695.00
Option	<input type="text"/>	695.00
Option	<input type="text"/>	695.00

- Aluminium polished
- Traffic white
- Other RAL color

Option	<input type="text"/>	995.00
Option	<input type="text"/>	895.00
Option	<input type="text"/>	895.00

Backrest

Backrest - canes with tension adjustable sling and cushion

Upholstery height:		
12.25"	WAMD	\$ 111
13.00"	WAMD	\$ 111
13.75"	WAMD	\$ 111
14.5"	WAMD	\$ 111
15.5"	WAMD	\$ 111
16"	WAMD	\$ 111

OR

Backrest - V-Trak "Dynamic Stability" with internal adjustable straps and adjustable laterals (Flexes to absorb energy, .25" padded/breathable upholstery) (must order mounting hardware)

V-TRAK Axxis with parallel sides

Parallel Sides with 2-3 inches of contour depth

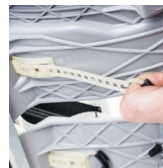

Internal adjustable spine profiling straps



Internal adjustable lateral support



Width	M	L	XL
Adjustable:	Inside Width 9.5"-12"	Inside Width 11"-13.5"	Inside Width 13.5"-15.75"
1 Height 12"	\$695 <input type="checkbox"/> E2620	\$695 <input type="checkbox"/> E2620	\$750 <input type="checkbox"/> E2620
2 Height 15.75"	\$695 <input type="checkbox"/> E2620	\$695 <input type="checkbox"/> E2620	\$750 <input type="checkbox"/> E2620
3 Height 21.5"	\$750 <input type="checkbox"/> E2620	\$775 <input type="checkbox"/> E2620	\$795 <input type="checkbox"/> E2620

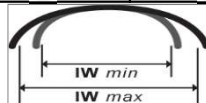

V-TRAK Axxis Deep Contour (Lateral crest is always 22cm from bottom)

Deep contour with 5-7 inches of contour depth



Internal adjustable spine profiling straps

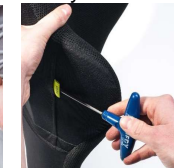

Internal adjustable lateral support - Lateral adjustment for front of backrest



Width	M	L	XL	XXL
Adjustable:	Inside Width 9.5"-12"	Inside Width 11"-13.5"	Inside Width 13.5"-15.75"	Inside Width 14"-21.5"
4 Height 21.5"	\$775 <input type="checkbox"/> E2620	\$795 <input type="checkbox"/> E2620	\$825 <input type="checkbox"/> E2620	\$850 <input type="checkbox"/> E2620
5 Height 23.5"	\$775 <input type="checkbox"/> E2620	\$795 <input type="checkbox"/> E2620	\$825 <input type="checkbox"/> E2620	\$850 <input type="checkbox"/> E2620

Mounting Hardware - Adjustable

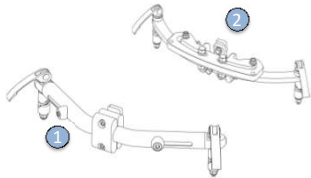

1	Lite - tube style			\$	292
	Additional set (recommended for standing)			\$	292
2	Original - flat style (recommended for chair back widths over 19")			\$	292
	Additional set (recommended for standing)			\$	292

Backrest options



3	Standard Backrest - 6" tube extension for sling back (standard back height is 16", this item extends it to 22")			\$	369
	V-Trak backrest - 8" extension			\$	543

Backrest angle

85°	Option		•
90°	Std.		•
95°	Option		•

Seat Cushion - memory foam with cover

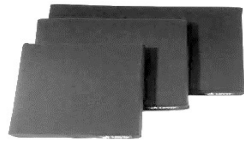

Seat width ▶	13.75"	15"	15.75"	16.5"	17.75"	19"			
Seat depth ▼									
Matches seat depth unless otherwise specified									
									\$ 397

Additional Seat Cushion Cover

Standard	SESND1050		\$	219
Incontinent	SESND1055		\$	219

Supports



1	Knee support - Padded and reinforced			\$	172
2	Rectangular knee wedge	2" x 4"	SEFND0035	\$	35
		2.5" x 4"	SEFND0035	\$	35
		3" x 4"	SEFND0035	\$	35
		2" x 6"	SEFND0035	\$	35
		3" x 6"	SEFND0035	\$	35
3	Conical knee wedge	2" - 4" x 4"	SEFND0035	\$	35
		3.5" - 4.5" x 4"	SEFND0035	\$	35
		5" - 7" x 4"	SEFND0035	\$	35
4	Knee support - Sport			\$	295
5	Knee support - Polyurethane, rigid tube, swingaway	Size S (4" - 4.75")		\$	545
		Size M (5.5" - 6.5")		\$	545
	Calf strap (see pict #1 below)		SEFND0010	X	\$ 73
	Chest support belt		SEFND0030	X	\$ 120
6	Additional Chest support - BodyPoint Universal Neoprene- 4.5" wide - SP110L			\$	195
7	Shoe Holder	3.75" x 7.25" Small Right		\$	213
		3.75" x 7.25" Small Left		\$	213
		4.5" x 8" Large Right		\$	233
		4.5" x 8" Large Left		\$	233

Footrest



1	One piece footplate, fixed	SEFND0015		\$	95
2	Two-piece footplate, flip-up			\$	285
3	One piece footplate, flip-up (back) (not available with footrest height adapter)			\$	219
2	Footplate height adapter (available only with one piece footplate, fixed) (footplate will be 1" narrower than normal)	For seat widths 15", 17.75" & 19"		\$	69
		For seat widths 15.75" & 16.5"		\$	225
4	Easy transfer footplate (extended "L" brackets bring footplate closer to the floor)	Footplate Depth 8"		\$	388
		Footplate Depth 10.25"		\$	388
	Detachable legrest/downposts			\$	149
	Non-slip footplate surface			\$	129

Footplate angle																		
			80°	<input type="text"/>	\$ 99													
			90°	<input type="text"/>	\$ 99													
			100°	<input type="text"/>	\$ 99													
Rear wheel position																		
<p>There are multiple Axle Blocks available on the LCEV allowing modifiable fore/aft positions of the rear axle and wheel. The chair comes delivered with the rear Axle Block (and rear wheel position) that provides the most optimum propelling characteristics for the client. For further information, please contact customer service.</p>																		
Wheel options																		
		Tire - 26"x1" high pressure pneumatic, hub black, spoke silver with 6" front caster	Pair	<input type="text"/>	\$ 325													
		Tire - 24" Solid Polyurethane	Pair	<input type="text"/>	\$ 159													
	1	Spinegy wheel - 24" w/black Marathon tire																
			<table border="1"> <thead> <tr> <th>Red</th> <th>Black</th> <th>White</th> <th></th> </tr> </thead> <tbody> <tr> <td><input type="checkbox"/></td> <td><input type="checkbox"/></td> <td><input type="checkbox"/></td> <td>12 Spoke</td> </tr> <tr> <td><input type="checkbox"/></td> <td><input type="checkbox"/></td> <td><input type="checkbox"/></td> <td>18 Spoke</td> </tr> </tbody> </table>	Red	Black	White		<input type="checkbox"/>	<input type="checkbox"/>	<input type="checkbox"/>	12 Spoke	<input type="checkbox"/>	<input type="checkbox"/>	<input type="checkbox"/>	18 Spoke	Pair	<input type="text"/>	\$ 925
	Red	Black	White															
	<input type="checkbox"/>	<input type="checkbox"/>	<input type="checkbox"/>	12 Spoke														
	<input type="checkbox"/>	<input type="checkbox"/>	<input type="checkbox"/>	18 Spoke														
				Pair	<input type="text"/>	\$ 697												
		Not available when using hub lock, drum brakes or one arm drive																
	2	Camber																
				3°	<input type="text"/>	\$ 274												
				6°	<input type="text"/>	\$ 274												
	Not available when using hub lock, drum brakes or one arm drive																	
3	Steel hand rim		Pair	<input type="text"/>	\$ 132													
4	Maxgrepp - Original handrim with rubber coating		Pair	WAMO	\$ 578													
5	Maxgrepp - Ergo Para CP handrim		Pair	<input type="text"/>	\$ 995													
6	Rear wheels - hub lock brake		Pair	<input type="text"/>	\$ 550													
7	One arm drive		Right	WAML	\$ 1,595													
	Available only with standard wheels		Left	WAML	\$ 1,595													
Accessories																		
1	Tray table with hardware - removeable			SETND0005	\$ 378													
2	Push handles		Pair	<input type="text"/>	\$ 175													
3	Push handles - 2.75" extension		Pair	<input type="text"/>	\$ 338													
4	Push handles - detachable, height adjustable 1" - 6"		Pair	<input type="text"/>	\$ 349													
5	Anti Tips - traditional		Pair	<input type="text"/>	\$ 152													
6	Anti Tips - swingaway with attendant tip aid		Pair	<input type="text"/>	\$ 450													
	XL Adapter																	
	Necessary with swingaway anti-tips on extra long (XL) frame		Pair	<input type="text"/>	\$ 152													
7	Tip Aid - attendant		Pair	<input type="text"/>	\$ 85													
8	Spoke guard - transparent		Pair	WAMP	\$ 186													
9	Shoe holder		Pair	<input type="text"/>	\$ 426													
10	Wheel lock extension - 2.5"		Pair	<input type="text"/>	\$ 150													
11	Seat depth and footrest quick adjustment kit			<input type="text"/>	\$ 129													
	Includes 10 clamps with post and 4 threaded knobs																	
12	Frame reinforcement kit			<input type="text"/>	\$ 290													
	Necessary when e-fix or similar system is mounted																	
	Anti-tips - swingaway required																	
	Cannot be used with Hub Lock Brakes or Anti Tips - traditional																	
	Vehicle tie-down kit			<input type="text"/>	\$ 988													
	Fixed attachment points for chair transport																	
	Includes frame reinforcement kit																	
	Anti-tips - swingaway required																	
	Mandatory if client is transported in vehicle. Chair required to be secured with the Q'Straint 5001-T2 or any restraint system certified by Q'Straint 5001-T2. Occupant must be secured using the Q'Straint Vehicle 3 point or any restraint system certified by ISO 10542/2 standards.																	

Remarks